

# ELEVATION CERTIFICATE

OMB No. 1660-0008  
Expires March 31, 2012

National Flood Insurance Program

**Important: Read the instructions on pages 1-9.**

## SECTION A - PROPERTY INFORMATION

For Insurance Company Use:

A1. Building Owner's Name **Santa Paula Investment Team LLC**

Policy Number

A2. Building Street Address (including Apt., Unit, Suite, and/or Bldg. No.) or P.O. Route and Box No.

Company NAIC Number

**709**  
**910** Mission Rock Road

City **Santa Paula** State **CA** ZIP Code **93060**

A3. Property Description (Lot and Block Numbers, Tax Parcel Number, Legal Description, etc.)

APN **099-0-060-545 & 099-0-060-535**

A4. Building Use (e.g., Residential, Non-Residential, Addition, Accessory, etc.) Non-Residential

A5. Latitude/Longitude: Lat. **34-18'-50.57" N** Long. **119-06'08.82" W**

Horizontal Datum:  NAD 1927  NAD 1983

A6. Attach at least 2 photographs of the building if the Certificate is being used to obtain flood insurance.

A7. Building Diagram Number **1A**

A8. For a building with a crawlspace or enclosure(s):

- a) Square footage of crawlspace or enclosure(s) **N/A** sq ft  
 b) No. of permanent flood openings in the crawlspace or enclosure(s) within 1.0 foot above adjacent grade **N/A**  
 c) Total net area of flood openings in A8.b **N/A** sq in  
 d) Engineered flood openings?  Yes  No

A9. For a building **INDUSTRIAL** with an attached garage:

- a) Square footage of attached garage **10500** sq ft  
 b) No. of permanent flood openings in the attached garage within 1.0 foot above adjacent grade **0**  
 c) Total net area of flood openings in A9.b **N/A** sq in  
 d) Engineered flood openings?  Yes  No

## SECTION B - FLOOD INSURANCE RATE MAP (FIRM) INFORMATION

B1. NFIP Community Name & Community Number  
**Ventura County (Unincorporated Areas) 060413**

B2. County Name  
**Ventura County**

B3. State  
**California**

B4. Map/Panel Number  
**06111C0778**  
**PANEL 778 of 1275**

B5. Suffix  
**E**

B6. FIRM Index Date  
**1/20/2010**

B7. FIRM Panel Effective/Revised Date  
**1/20/2010**

B8. Flood Zone(s)  
**X & AE**

B9. Base Flood Elevation(s) (Zone AO, use base flood depth)  
**191.9'**

B10. Indicate the source of the Base Flood Elevation (BFE) data or base flood depth entered in Item B9.

FIS Profile  FIRM  Community Determined  Other (Describe) \_\_\_\_\_

B11. Indicate elevation datum used for BFE in Item B9:  NGVD 1929  NAVD 1988  Other (Describe) \_\_\_\_\_

B12. Is the building located in a Coastal Barrier Resources System (CBRS) area or Otherwise Protected Area (OPA)?  Yes  No  
Designation Date **N/A**  CBRS  OPA

## SECTION C - BUILDING ELEVATION INFORMATION (SURVEY REQUIRED)

C1. Building elevations are based on:  Construction Drawings\*  Building Under Construction\*  Finished Construction

\*A new Elevation Certificate will be required when construction of the building is complete.

C2. Elevations - Zones A1-A30, AE, AH, A (with BFE), VE, V1-V30, V (with BFE), AR, AR/A, AR/AE, AR/A1-A30, AR/AH, AR/AO. Complete Items C2.a-h below according to the building diagram specified in Item A7. Use the same datum as the BFE.

Benchmark Utilized **Ventura County X 304 RM1 Vertical Datum NAVD 88**

Conversion/Comments **N/A**

Check the measurement used.

- a) Top of bottom floor (including basement, crawlspace, or enclosure floor) **194.65**  feet  meters (Puerto Rico only)  
 b) Top of the next higher floor **N/A**  feet  meters (Puerto Rico only)  
 c) Bottom of the lowest horizontal structural member (V Zones only) **N/A**  feet  meters (Puerto Rico only)  
 d) ~~Attached garage~~ (top of slab) **BUILDING** **194.65**  feet  meters (Puerto Rico only)  
 e) Lowest elevation of machinery or equipment servicing the building (Describe type of equipment and location in Comments) **194.43**  feet  meters (Puerto Rico only)  
 f) Lowest adjacent (finished) grade next to building (LAG) **193.95**  feet  meters (Puerto Rico only)  
 g) Highest adjacent (finished) grade next to building (HAG) **194.51**  feet  meters (Puerto Rico only)  
 h) Lowest adjacent grade at lowest elevation of deck or stairs, including structural support **N/A**  feet  meters (Puerto Rico only)

## SECTION D - SURVEYOR, ENGINEER, OR ARCHITECT CERTIFICATION

This certification is to be signed and sealed by a land surveyor, engineer, or architect authorized by law to certify elevation information. I certify that the information on this Certificate represents my best efforts to interpret the data available. I understand that any false statement may be punishable by fine or imprisonment under 18 U.S. Code, Section 1001.

Check here if comments are provided on back of form. Were latitude and longitude in Section A provided by a licensed land surveyor?  Yes  No

Certifier's Name **William L. Meagher**

License Number **5948**

Title **Land Surveyor/Owner**

Company Name **WM Surveys Inc.**

Address **2747 Sherwin Ave., #12**

City **Ventura**

State **CA**

ZIP Code **93003**

Signature 

Date **2/19/2013**

Telephone **805-677-4850**

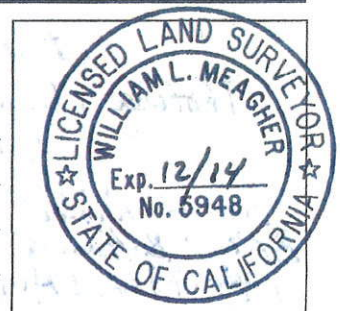



# Building Photographs

See Instructions for Item A6.

209

Building Street Address (including Apt., Unit, Suite, and/or Bldg. No.) or P.O. Route and Box No. 910 Mission Rock Road	For Insurance Company Use: Policy Number
City Santa Paula State CA ZIP Code 93060	Company NAIC Number

If using the Elevation Certificate to obtain NFIP flood insurance, affix at least two building photographs below according to the instructions for Item A6. Identify all photographs with: date taken; "Front View" and "Rear View"; and, if required, "Right Side View" and "Left Side View." If submitting more photographs than will fit on this page, use the Continuation Page, following.

1/30/2013 FRONT VIEW (EAST SIDE)

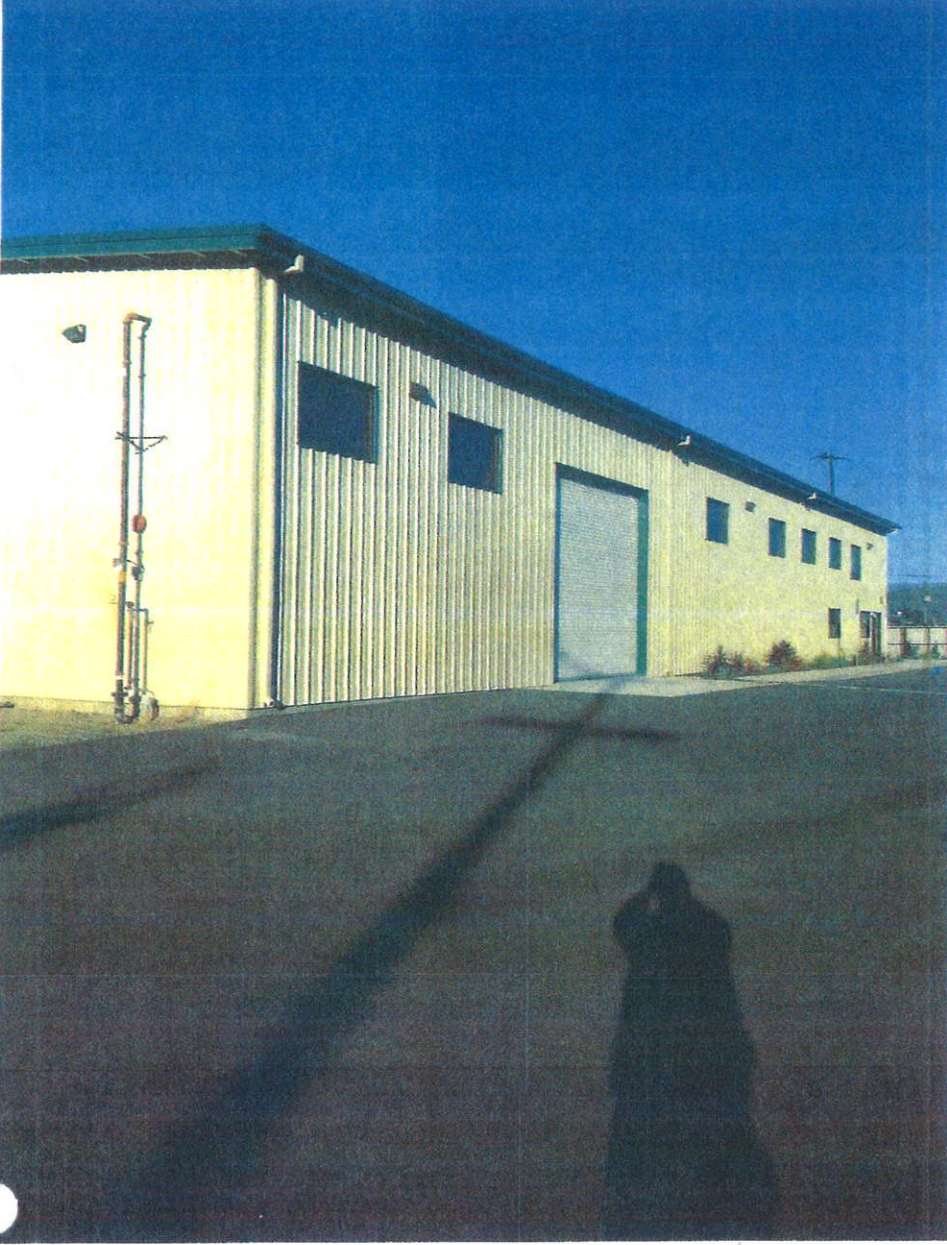



1/30/2013 REAR VIEW (WEST SIDE)



ELEC  
194.45'

AC  
194.43'

ELEC  
194.59'



2/13/2013 SOUTH SIDE



2/13/2013 SOUTH SIDE







FEMA

W-12023

March 26, 2012

MEMORANDUM FOR: Write Your Own (WYO) Principal Coordinators and the  
National Flood Insurance Program (NFIP) Servicing Agent

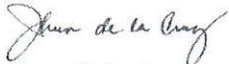
FROM:   
Jhun de la Cruz  
Chief, Underwriting Branch  
Risk Insurance Division

SUBJECT: Elevation Certificate and Floodproofing Certificate

The current versions of the NFIP Elevation Certificate (FEMA Form 81-13) and the Floodproofing Certificate (FEMA Form 81-65) show an expiration date of March 31, 2012. Newly revised editions of these two forms are undergoing review by the Office of Management and Budget (OMB); however, approval of the revised forms is not expected until after March 31, 2012. While FEMA is awaiting OMB approval for the forms, the current versions that show the March 31, 2012, OMB expiration dates may continue to be used.

When the new forms are approved, FEMA will permit a “phase-in” of the new Elevation Certificate and Floodproofing Certificate on a voluntary basis. During a 12-month transition period following the introduction of the new forms, we will accept either the new form or the old form. This voluntary transition period will allow for sufficient time for coordination and training of all affected NFIP stakeholders. Elevations and floodproofing certified after the last day of the transition period must be submitted on the new Elevation Certificate or Floodproofing Certificate.

The proposed changes to the forms are minor. We will make the new Elevation Certificate and Floodproofing Certificate available on the FEMA website following receipt of OMB approval.

If you have any questions regarding this matter, please contact Mary Ann Chang at 202-212-4712.

cc: Vendors, IBHS, FIPNC, FEMA Regions, Government Technical Representative

Required Routing: Data Processing, Claims, Underwriting